

ASSEMBLY-04LS - STRUTS

FIGURE N° N° FIGURA	PART NUMBER CÓDIGO PEÇA	NOMENCLATURE / DESCRIPTION NOMENCLATURA / DESCRIÇÃO	QUANTITY PER SET QTDE. POR CONJUNTO	MEASURE UNIT UNID. DE MEDIDA
01	SE-131.003	RIGHT MAIN STRUT	1	PC
(01)	SE-131.047	LEFT MAIN STRUT	1	PC
02	PN-705.008	POP RIVET 4,8X14,3	8	PC
03	PN-705.006	POP RIVET 4,8X11,1	30	PC
04	PE-131.033	BOLT	1	PC
05	PE-131.005	LOWER END	1	PC
06	DIN 125 A2 M8	FLAT WASHER	3	PC
07	DIN 985 A2 M8	LOCK NUT	2	PC
08	PE-131.031	BOLT	1	PC
09	PE-131.004	UPPER END	1	PC
10	PE-131.008	LOCK	1	PC
11	SE-131.045	BOLT	2	PC
12	DIN 125 A2 M5	FLAT WASHER	2	PC
13	DIN 934 A2 M5	NUT	2	PC
14	SE-131.001	RIGHT "V" STRUT	1	PC
(14)	SE-131.002	LEFT "V" STRUT	1	PC
15	SE-610.016-2	PITOT TUBE	1	PC
16	SE-131.019-2	BOLT	1	PC
17	PN-703.019	WASHER	7	PC
18	DIN 125 A2 M6	FLAT WASHER	2	PC
19	PE-131.035	BOLT	1	PC
20	PE-131.015	TUBE END	1	PC
21	DIN 985 A2 M6	LOCK NUT	1	PC
22	PE-131.037-2	BOLT	1	PC
23	SE-131.016	PLATE	1	PC
24	SE-131.018	PLATE	1	PC
25	PE-131.032-2	BOLT	1	PC
27	SE-131.025	LOCK NUT	4	PC
28	SE-131.030	LOCK NUT	1	PC
29	SE-131.012	"N" STRUT TUBE	1	PC

ASSEMBLY-04LS - STRUTS

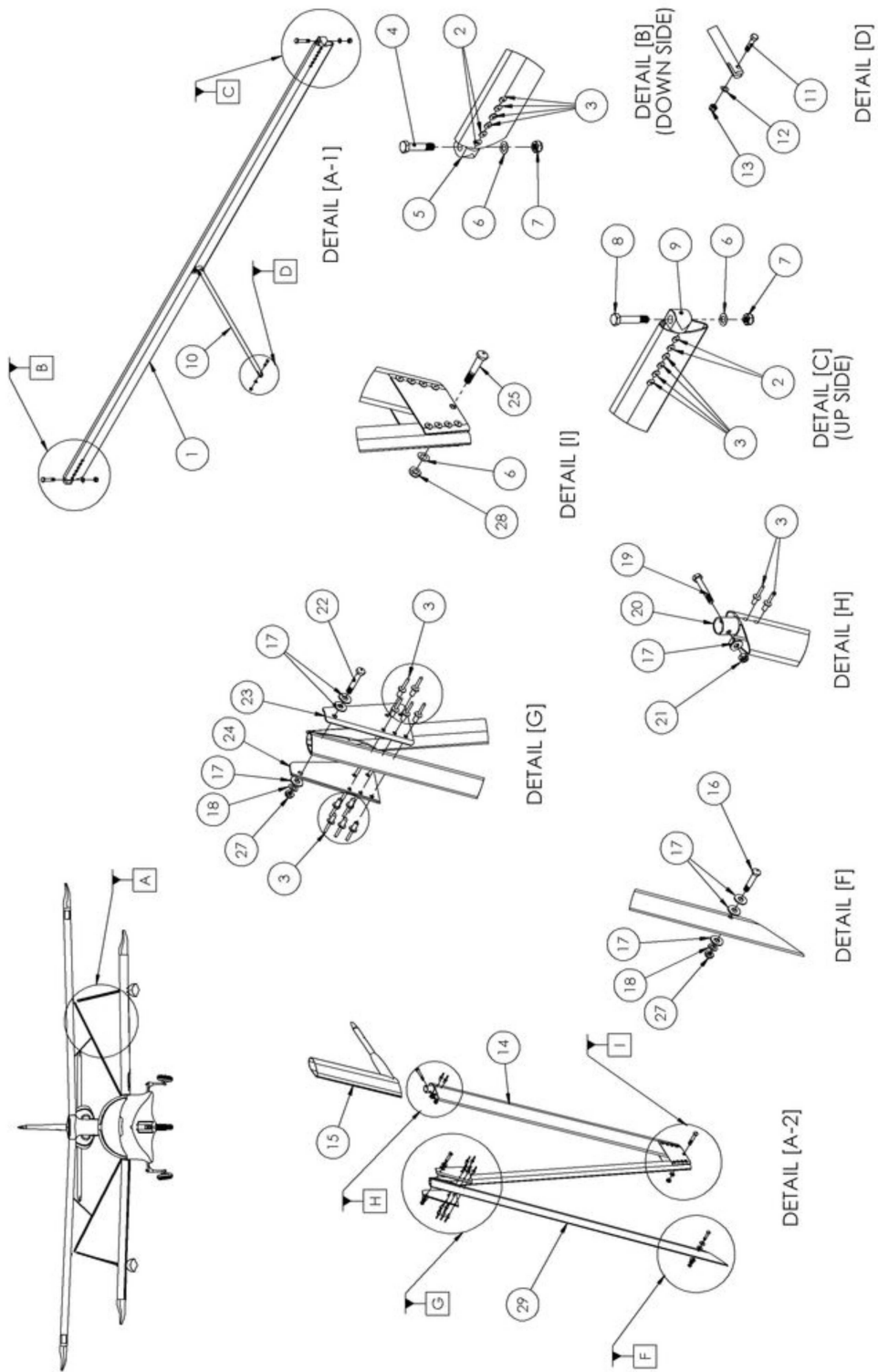

Alpha Numeric Parts List Lista de Peças Alfanumérico

PART NUMBER CÓDIGO PEÇA	ASSEMBLY CONJUNTO	PAGE N° N° PÁGINA	FIGURE N° N° FIGURA
DIN 125 A2 M5	ASSEMBLY-04LS	1	12
DIN 125 A2 M6	ASSEMBLY-04LS	1	18
DIN 125 A2 M8	ASSEMBLY-04LS	1	06
DIN 934 A2 M5	ASSEMBLY-04LS	1	13
DIN 985 A2 M6	ASSEMBLY-04LS	1	21
DIN 985 A2 M8	ASSEMBLY-04LS	1	07
PE-131.004	ASSEMBLY-04LS	1	09
PE-131.005	ASSEMBLY-04LS	1	05
PE-131.008	ASSEMBLY-04LS	1	10
PE-131.015	ASSEMBLY-04LS	1	20
PE-131.031	ASSEMBLY-04LS	1	08
PE-131.032-2	ASSEMBLY-04LS	1	25
PE-131.033	ASSEMBLY-04LS	1	04
PE-131.035	ASSEMBLY-04LS	1	19
PE-131.037-2	ASSEMBLY-04LS	1	22
PN-703.019	ASSEMBLY-04LS	1	17
PN-705.006	ASSEMBLY-04LS	1	03
PN-705.008	ASSEMBLY-04LS	1	02
SE-131.001	ASSEMBLY-04LS	1	14
SE-131.002	ASSEMBLY-04LS	1	(14)
SE-131.003	ASSEMBLY-04LS	1	01
SE-131.012	ASSEMBLY-04LS	1	29
SE-131.016	ASSEMBLY-04LS	1	23
SE-131.018	ASSEMBLY-04LS	1	24
SE-131.019-2	ASSEMBLY-04LS	1	16
SE-131.025	ASSEMBLY-04LS	1	27
SE-131.030	ASSEMBLY-04LS	1	28
SE-131.045	ASSEMBLY-04LS	1	11
SE-131.047	ASSEMBLY-04LS	1	(01)
SE-610.016-2	ASSEMBLY-04LS	1	15